

PLAN SHOWING PROPOSED  
 CONSTRUCTION RESIDENTIAL HOUSE  
 IN P.T.C COLONY 3rd STREET DF SNO  
 8/2 OF RAJAKILPAKKAM VILLAGE 174  
 SEMBAKKAM, SAIDAPET TALUK, CHENGAI  
 -ANNA DIST. Scale-1:100 & 200



SCHEDULE OF JOINERY

D	DOOR	1 10X210
D	DOOR	91X198
D	DOOR	75X198
W	WINDOW	122X135
G	GRILL	180 X 120
J	JOLLIES	75 X 122

REFERENCE

	SET	SM
PLOT AREA	3233.7	300.4
PLINTH AREA	752.8	69.9
F S I	0.23	
COVERAGE	23%	

COLOUR INDEX

PROPOSED	
EXG ROAD S	
SITE PLAN	

*R. Jayapragm*  
 OWNER

*M. Palani*  
 M. PALANI, D.C.E.  
 Licensed Surveyor  
 Tambaram Municipality  
 141/E, Velachery Main Road  
 MADRAS-600 073

LICENSED SURVEYOR

SAMPS DESIGN

141/E Velachery Main Road,  
 Mahalakshmi Nagar, MS-73

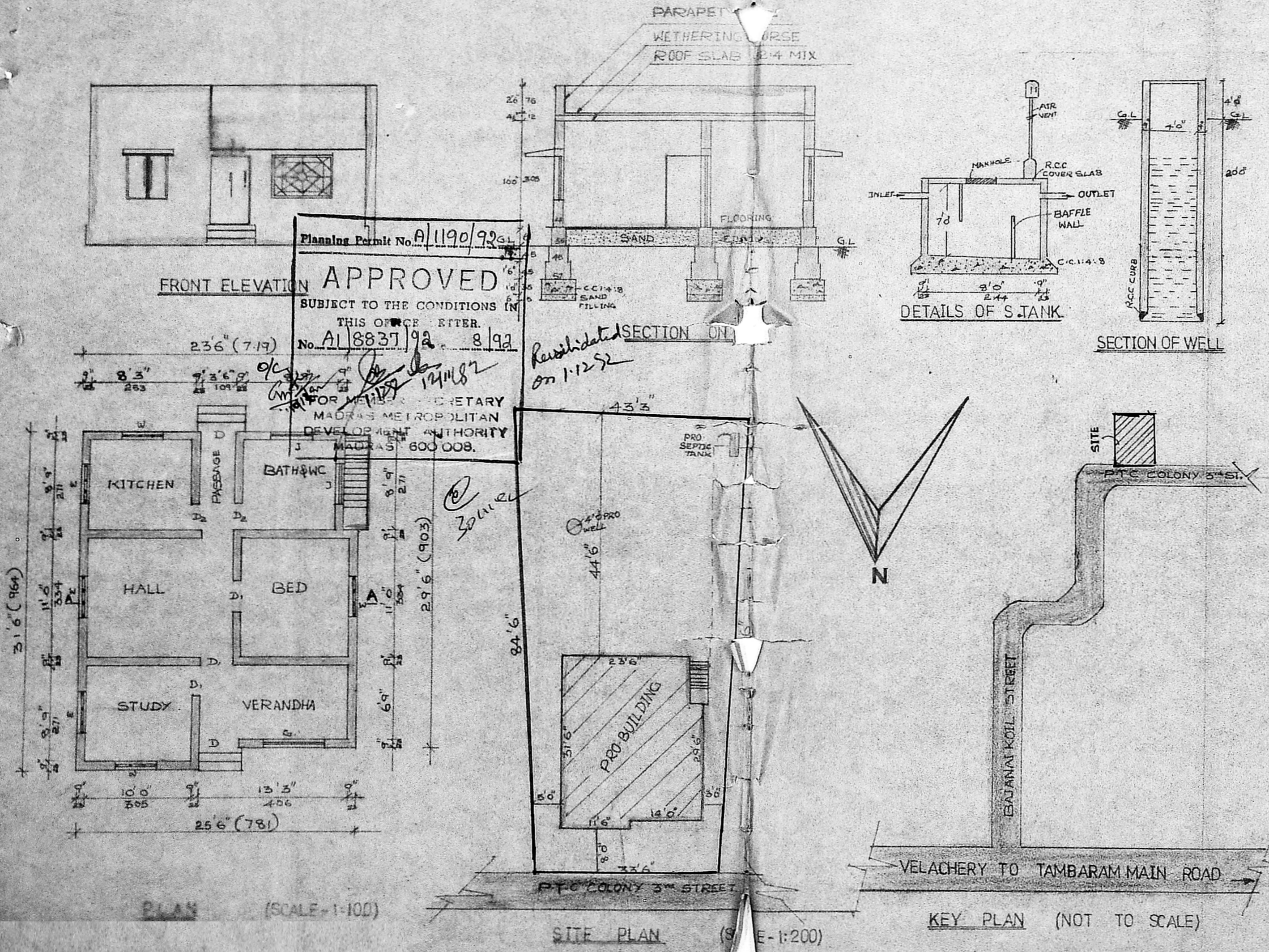

Planning Permit No. A/1190/92  
**APPROVED**  
 SUBJECT TO THE CONDITIONS IN  
 THIS OFFICE ORDER.  
 No. A/8837/92. 8/92  
 FOR MEMO SECRETARY  
 MADRAS METROPOLITAN  
 DEVELOPMENT AUTHORITY  
 MADRAS-600 008.

Resubmitted  
 on 1.12.52

PLAN (SCALE-1:100)

SITE PLAN (SCALE-1:200)

KEY PLAN (NOT TO SCALE)